



rini

Medical Ergonomics made in Sweden

MEDICONTUR  
— AVI —



[www.rinicompany.com](http://www.rinicompany.com)

[www.medicontur.es](http://www.medicontur.es)

Catálogo de Productos  
2023 issue 1



Table Of Contents	Side
1. Operating tables - RiEye Mk2S	3
2. Surgeon chairs - Carl	5
3. Patient chairs & Device tables	7
4. Other MedTech-products	9
5. General Terms and Conditions	13

## Welcome to Rini!

We are a Swedish company with innovative research and development and have since mid 1990 been a quality supplier of ergonomic products and solutions to medical professionals. We have our own sales and support organization in Sweden and work mainly with appointed distributors on our export markets.

### **Our business strategy is simple!**

**Rini offers ergonomic products and solutions uniquely tailored to different treatment areas. Giving doctors and associated personnel a maximum comfortable and productive work environment.**

The close contact we have with many highly qualified users is exciting and a positive challenge to continue to develop our products further - always with customer satisfaction in focus! **Read more at [www.rinicompany.com](http://www.rinicompany.com)**

Rini is a quality certified supplier according to ISO 13485.



Contact us by phone +46 8 594 77170 or E-mail [info@rini.se](mailto:info@rini.se) and we will tell you more!

## 1. Operating tables

### Operating table RiEye Mk2S

**Product code Description**

- 100-00105-05 RiEye Mk2S Operating table R5 – Suitable for shorter treatments such as injections
- Vertical leg support easier for patient to sit in the table straight from the front
  - Quick and safe positioning of the patient with Rini's patented "HandsFree" head support
  - Headrest with an unique ergonomic design
  - Option to save 6 user positions
  - Steady takes patient weights up to 300Kg
  - Adaptive chassis means RiEye Mk2S stands firmly on uneven floors
  - The chairs are mobile and can also be moved sideways
  - Short leg cushion 400mm long



- 100-00105-06 RiEye Mk2S Operating table – R6 Suitable for longer treatment
- Slightly angled leg pad in the lowest position, patient sits down from the front or side
  - Quick and safe positioning of the patient with Rini's patented "HandsFree" head support
  - Headrest with an unique ergonomic design
  - Option to save 6 user positions
  - Steady takes patient weights up to 300Kg
  - Adaptive chassis means RiEye Mk2S stands firmly on uneven floors
  - The chairs are mobile and can also be moved sideways
  - Long leg cushion 500mm long



- 100-00105-07 RiEye Mk2S Operating table R7 – Suitable for longer treatments, including anesthesia operations
- Angled leg pad in lowest position patient sits from side
  - Quick and safe positioning of the patient with Rini's patented "HandsFree" head support
  - Headrest with an unique ergonomic design
  - Option to save 6 user positions
  - Steady takes patient weights up to 300Kg
  - Adaptive chassis means RiEye Mk2S stands firmly on uneven floors
  - The chairs are mobile and can also be moved sideways
  - Extra long leg cushion 680mm



### Colors selection for ILLUSION cushion kits, Phthalate-free PU, Martindale 500.000

Product code	Description	R5	R6	R7
140-00331-xx	ILLUSION cushion kit blue	-00	-01	-02
140-00333-xx	ILLUSION cushion kit black	-00	-01	-02
140-0033x-xx	ILLUSION cushion kit other colors	-00	-01	-02
140-00285-xx	Extra wide cushion kit	-00	-01	-02

## Accessories for operating table RiEye Mk2S

Accessories marked with \* must be factory mounted

Product code	Description
140-00229-01	Electrical headrest *
140-00270-00	Headrest X-Tray, replaces EasyFix (standard) headrest
140-00270-01	Pillow for X-Tray black (300x265mm WxL)
140-00270-02	Pillow for X-Tray grey
140-00270-03	Headrest S-Tray, replaces EasyFix (standard) headrest
140-00270-04	Pillow for S-tray (210x180mm WxL)
140-00252-02	Headrest S-Tray Nippon, replaces EasyFix (standard) headrest
140-00252-05	Headrest X-Tray FaceDown , replaces EasyFix (standard) headrest
140-00270-06	Pillow for X-Tray FaceDown
140-00235-02	Accessory rail for S-Tray and X-Tray
000-03420-16	Foundation for headrests to make headrest dockable
140-00230-01	Foot control with two joysticks movable tray
140-00230-02	Foot control with two joysticks fixed tray, cannot be combined with electric headrest
140-00261-01	Auto access to memory location
140-00266-01	Electrical brake and direction control *
140-00352-00	<b>New</b> Reverse trendelenburg max 12° *
140-00163-00	Anaesthesia armrest, clamp and arm strap included
140-00350-00	Width extension back rest right 410mm
140-00350-01	Width extension back rest left 410mm
140-00232-00	Length extension back rest 120mm
140-00242-01	Wrist support EasyFix
140-00242-02	Wrist support S-Tray and X-Tray
140-00259-00	Driving handle backrest foldable R/L
140-00256-00	Driving handle leg foldable R/L R6 and R7
140-00256-01	Driving handle leg R/L R5
140-00235-00	Attachment rail for accessories on the seat R or L 250mm
140-00235-01	Attachment rail for accessories on the seat R or L 250mm if Side rail is mounted
140-00236-00	Drape support
140-00236-01	Drape support, formable with air tube connection
140-00237-02	Battery lead (1pc is standard)
140-00237-04	<b>New</b> Battery Lithium iron, low weight and higher capacity
140-00238-01	Holder for hand control unit flexible, bracket included
140-00238-02	Holder for hand control unit fixed, bracket included
140-00238-03	Holder for hand control unit fixed for IV pole, bracket included
140-00239-01	IV pole, bracket included
140-00240-00	Side rail collapsible right side
140-00240-01	Side rail collapsible left side
140-00320-00	Armrest for Side rail collapsible *
140-00240-02	Side rail right or left side 600mm, 140-00235-00 included
140-00351-00	<b>New</b> Bracket for oxygen tank
140-00251-00	Leg cushion cover R6 R7
140-00251-01	Leg cushion cover R5
140-00263-00	Belt waist
140-00263-01	Belt arm 700mm
140-00263-02	Belt leg 2100mm
140-00265-00	Leg support circular 150mm
140-00265-01	Leg support half circular 200mm

## 2. Surgeons chairs

### Surgeon chairs Carl MK2, a new generation of electrically controlled chairs

**Product code Description**

- 120-00133-03 Carl Mk2 R5 - Easy arm support
- Uniquely designed frame with three wheels for high availability
  - Electric controlled central brake
  - Seat height from 490 to 800mm
  - Seat 420x460mm back support 300x350mm (LxW)
  - Battery-operated, charger is connected to chair
  - Back and seat can be adjusted in height and angle
  - The chair is equipped with Easy arm support



**Product code Description**

- 120-00133-00 Carl Mk2 R6 - Rilis arm support
- Uniquely designed frame with three wheels for high availability
  - Electric controlled central brake
  - Seat height from 490 to 800mm
  - Seat 420x460mm back support 300x350mm
  - Battery-operated, charger is connected to chair
  - Back and seat can be adjusted in height and angle
  - The chair is equipped with Rilis safety arm support



**Product code Description**

- 120-00133-01 Carl Mk2 R7 - One hand grip support
- Uniquely designed frame with three wheels for high availability
  - Electric controlled central brake
  - Seat height from 490 to 800mm
  - Seat 420x460mm back support 300x350mm
  - Battery-operated, charger is connected to chair
  - Back and seat can be adjusted in height and angle
  - The chair is equipped with one hand grip support



**Product code Description**

- 120-00133-02 Carl Mk2 R8 - FlexiDoc
- Uniquely designed frame with three wheels for high availability
  - Electric controlled central brake
  - Seat height from 490 to 800mm
  - Seat 420x460mm back support 300x350mm
  - Battery-operated, charger is connected to chair
  - Back and seat can be adjusted in height and angle
  - With FlexiDoc armrests for the most demanding procedures



### Upholstery and color (state when ordered)

Product code	Description	Blue	Black
140-00118-xx	Cushion kit vinyl	-00	-02
140-00247-xx	Cushion kit art leather	-00	-02
140-00306-xx	Cushion kit soft padding	Not offered	-02
140-00321-xx	Saddle seat Amazone	Not offered	-02
140-00322-xx	Saddle seat Jumper	Not offered	-02

Vinyl has an airy, ventilated slick texture and is not so hot, good for long sessions  
Artificial leather has a denser structure and are easier to clean

### Options for One hand grip armrest R7

**Product code Description**

- 140-00323-00 Arm cushion soft and convex shape  
140-00323-01 Arm cushion soft and rectangular shape 400x110mm (LxW)  
140-00324-00 Extended height adjustment 350mm (225mm)

### Option for Carl Mk2

**Product code Description**

- 140-00327-00 Pedal platform 600x680mm (WxL) can be retrofitted



## Surgeon chairs Carl 4 - electrically controlled chairs

Product code	Description
120-00102-04	Carl 4 Foot R5 - Easy arm support
120-00102-00	Carl 4 Foot R6 - Rilis arm support
120-00102-02	Carl 4 Foot R7 - One hand grip support
120-00102-05	Carl 4 Heel R5 - Easy arm support
120-00102-01	Carl 4 Heel R6 - Rilis arm support
120-00102-03	Carl 4 Heel R7 - One hand grip support

- Low friction, large 100mm castors
- Seat height from 490 to 800mm
- Seat 420x460mm back support 300x350mm (LxW)
- Back and seat can be adjusted in height and angle
- Battery-operated, charger is connected to chair
- Foot controlled brake, brakes at both rear wheels



Foot R7



Heel R6



Heel R5

## Surgeon chairs Carl - manually controlled chairs

Product code	Description
120-00100-00	Carl Spring R6 - Rilis arm support
120-00100-01	Carl Spring R7 - One hand grip support

- Foot controlled height adjustment with ring
- Seat height from 540 to 680mm
- Seat 420x460mm back support 300x350mm
- Seat and back can be adjusted in height and angle
- Foot controlled brake, brakes at both rear wheels



R6



R7

120-00101-00	Carl Swing R6 - Rilis arm support
120-00101-01	Carl Swing R7 - One hand grip support

- Foot controlled height adjustment with ring
- Seat height from 500 to 700mm
- Seat 420x460mm back support 300x350mm
- An easily moved and rotatable chair
- Back and seat can be adjusted in height and angle



R6



R7

## Upholstery and color (state when ordered)

Product code	Description	Blue	Black	
140-00118-xx	Cushion kit vinyl	-00	-02	
140-00247-xx	Cushion kit art leather	-00	-02	
140-00306-xx	Cushion kit soft padding	Not offered	-02	(For Carl 4 Foot och Heel)
140-00321-xx	Saddle seat Amazon	Not offered	-02	(For Carl 4 Foot och Heel)
140-00322-xx	Saddle seat Jumper	Not offered	-02	(For Carl 4 Foot och Heel)

Vinyl has an airy, ventilated slick texture and is not so hot, good for long sessions  
Artificial leather has a denser structure and are easier to clean

140-00129-01 **New** Footrest Carl 4 Foot

## Options for One hand grip armrest R7

Product code	Description
140-00323-00	Arm cushion soft and convex shape
140-00323-01	Arm cushion soft and rectangular shape 400x110mm (LxW)
140-00324-00	Extended height adjustment 350mm (225mm)

### 3. Patient chairs & Device tables

#### Patient chairs Malin - electric controlled

**Product code Description**

- 120-00103-00 Malin Rock - hand controlled
- Low friction large 100mm castors with double ball bearing wheels
  - Lifting capacity from 500 to 800mm
  - Seat 450x470mm back support 370x400mm (LxW)
  - Battery powered
  - Stable manage patient weights up to 150Kg



- 120-00103-01 Malin Swing - hand controlled
- Seat can be rotated  $\pm 90^\circ$
  - Low friction large 100mm castors with double ball bearing wheels
  - Lifting capacity from 500 to 800mm
  - Seat 450x470mm back support 370x400mm
  - Battery powered
  - Stable manage patient weights up to 150Kg



- 120-00103-02 Malin Slim - hand controlled
- Wheelbase for narrow floor space under the table
  - Low friction large 100mm castors with double ball bearing wheels
  - Lifting capacity from 500 to 800mm
  - Seat 450x470mm back support 370x400mm
  - Battery powered
  - Stable manage patient weights up to 150Kg



#### Options:

**Product code Description**

- 140-00128-00 Extended lifting capacity from 540mm to 940mm  
 140-00126-00 Wire less hand control infrared 1ch  
 140-00126-01 Wire less hand control infrared 2ch (if electrical brake)  
 140-00250-00 Electrical brake by the standard hand control  
 140-00315-00 Wheels with direction control

#### Accessories:

**Product code Description**

- 150-00102-00 Armrest standard left  
 150-00102-01 Armrest standard right  
 150-00103-00 Armrest collapsible left  
 150-00103-01 Armrest collapsible right  
 150-00105-00 Armrest for fluorescein photography left 350mm  
 150-00105-01 Armrest for fluorescein photography right 350mm  
 140-00129-00 Foot support plate of rubber, not for Malin Slim  
 140-00130-00 Foot support T-shaped of metal, not for Malin Slim  
 140-00132-00 Driving handle 450mm  
 140-00132-02 Driving handle 600mm  
 140-00260-00 Belt for patient  
 190-00018-00 Head support



#### Colors of cushion kit:

**Product code Description**

- 140-00135-00 Cushion kit blue  
 140-00135-02 Cushion kit black

## Device table Linnea

### Product code Description

- 130-00103-00 Linnea 850 - examination table
- Width between columns 850mm
  - Table top of beech laminate, size 1000x420x22mm
  - Electrically adjustable height from 690 to 1040mm
  - Manage weight up to 80Kg
  - Connected to 230 V
  - Equipped with safety brake for the patient

- 130-00109-00 Linnea Piccolo - examination table,
- Width between columns 720mm
  - Table top of light grey laminate, size 870x370/420x22mm
  - Electrically adjustable height from 580 to 1240mm
  - Manage weight up to 50Kg
  - Connected to 230 V
  - Equipped with low wheel base and two sockets 230V outlets as standard



## Examination table Linnea 850 table top variants:

### Product code Description

- 140-00142-00 Table top of beech laminate 1000x350x22mm
- 140-00143-00 Table top of beech laminate 1000x500x22mm
- 140-00144-00 Table top of beech laminate 1180x350x22mm, asymmetric
- 140-00145-00 Table top of grey laminate with birch edge 1000x450x38mm

## Examination table Linnea Piccolo table top variants:

### Product code Description

- 140-00150-00 Table top of light grey laminate, size 870x420x22mm
- 140-00145-03 Table top of grey laminate with birch edge 1000x420x38mm cut out for H-S chin support

## Options:

### Product code Description

- 140-00139-00 Low wheel base, table lowered with 75mm
- 140-00121-00 Control box mounted to column for more space beneath table top
- 140-00248-00 Factory mounted power outlet under table top



## Accessories:

### Product code Description

- 140-00272-00 Chin support bracket H-S 18mm
- 140-00272-01 Chin support bracket H-S 60mm



## 4. Other MedTech-products

### Special chairs for surgeons and assistants

**Product code** **Description**

- 120-00115-01 ComfortMove - foot controlled  
 120-00115-00 ComfortMove - hand controlled
- Ideal for long seating's, popular among anaesthetists
  - Thick and comfortable padding
  - Seat 430x400mm back support 300x290mm (LxW)

**Standard castors**

Castors 50mm low friction

Gas spring	Low	Medium	High
Max seat height, mm	570	700	820
Min seat height, mm	430	500	580



- 120-00105-01 RiFlex - foot controlled  
 120-00105-00 RiFlex - hand controlled
- Adjustable lower back support
  - Popular Assistant chair for eye or ear surgery
  - Seat 360x390mm back support 230x370mm

**Standard castors**

Castors 50mm low friction

Gas spring	Low	Medium	High
Max seat height, mm	570	690	870
Min seat height, mm	430	500	580



- 120-00104-01 Dynamic - foot controlled  
 120-00104-00 Dynamic - hand controlled
- Chair with unique dynamic lower back support
  - Popular operator chair within dental care
  - Seat 400x440mm back support 160x140mm

**Standard castors**

Castors 50mm low friction, brake unloaded

Gas spring	Low	Medium	High
Max seat height, mm	600	720	900
Min seat height, mm	460	530	620



- 120-00111-01 RiRest - foot controlled  
 120-00111-00 RiRest - hand controlled  
 120-00111-03 RiRest - backrest foot controlled  
 120-00111-02 RiRest - backrest hand controlled
- Soft seat small and movable
  - Popular within operating theaters
  - Seat ø330mm back support 230x370mm

**Standard castors**

Castors 50mm high friction

Gas spring	Low	Medium	High
Max seat height, mm	600	720	900
Min seat height, mm	460	530	620



120-00111-01



120-00111-02

### Upholstery

Description	Stamskin	Art leather	Leather	Vinyl
ComfortMove	Option	Std	Option	Option
CorrectSit	Std	Option	Option	Option
RiFlex	-	-	-	Std
Dynamic	Std	Option	Option	Option
RiRest	-	-	-	Std

**Color**

Product code	Description	Blue	Black	Other color
	ComfortMove	Option	Std	Option
	CorrectSit	Option	std	Option
140-00245-xx	RiFlex	-00	-02	-
	Dynamic	Option	Std	Option
140-00246-xx	RiRest	-00	-02	-

**Choice of castors**

Product code	Description
140-00122-00	Castors 50mm low friction - set
140-00122-01	Castors 50mm high friction - set

**Choice of gas spring**

Product code	Description
140-00124-00	Gas spring low hand controlled chair
140-00124-01	Gas spring medium hand controlled chair
140-00124-02	Gas spring high hand controlled chair
140-00124-03	Gas spring low foot controlled chair
140-00124-04	Gas spring medium foot controlled chair
140-00124-05	Gas spring high foot controlled chair

**Accessories**

Product code	Description
140-00183-00	Foot support foot controlled chairs
140-00182-00	Foot support hand controlled chairs

## Saddle chairs for surgeons and assistants

### Product code Description

120-00106-01	Amazone - saddle chair foot controlled
120-00106-00	Amazone - saddle chair hand controlled
120-00106-02	Amazone - back support hand controlled
120-00106-03	Amazone - back support foot controlled
120-00106-04	AmazoneBalance - hand controlled
120-00106-05	AmazoneBalance - foot controlled

- For you who find other saddle chairs too wide
- Thick and comfortable padding and tiltable seat
- Seat 340x350mm back support 210x330mm (LxW)

#### Standard castors

Castors 65mm break unloaded

Gas spring	Low	Medium	High
Max seat height, mm	570	690	820
Min seat height, mm	430	500	580



120-00106-03



120-00106-05

120-00110-01	Jumper - saddle chair foot controlled
120-00110-00	Jumper - saddle chair hand controlled
120-00110-02	Jumper - back support hand controlled
120-00110-03	Jumper - back support foot controlled
120-00110-04	JumperBalance - hand controlled
120-00110-05	JumperBalance - foot controlled

- A chair for longer sittings
- Excellent for you who wants a lower seat position
- Seat 360x430mm back support 210x330mm

#### Standard castors

Castors 65mm break unloaded

Gas spring	Low	Medium	High
Max seat height, mm	570	690	820
Min seat height, mm	430	500	580



120-00123-01	Perfect lite - saddle chair foot controlled
120-00123-00	Perfect lite - saddle chair hand controlled

- Easy to maintain clean due to a seamless upholstery
- A small chair, excellent for them who want a high seat position
- Seat 300x390mm

#### Standard castors

Castors 50mm low friction

Gas spring	Low	Medium	High
Max seat height, mm	570	690	820
Min seat height, mm	430	500	580



## Upholstery

Description	Stamskin	Art leather	Leather
Amazone	Option	Std	Option
Jumber	Option	Std	Option
Perfect classic	Option	Option	Std
Perfect lite	Option	Option	Spec

## Color

Name	Black	Other color
Amazone	Std	Option
Jumper	Std	Option
Perfect classic	Std	Option
Perfect lite	Std	Option

## Choice of castors

### Product code Description

140-00122-00	Castors 50mm low friction - set
140-00122-01	Castors 50mm high friction - set

## Choice of gas spring

### Product code Description

140-00124-00	Gas spring low hand controlled chair
140-00124-01	Gas spring medium hand controlled chair
140-00124-02	Gas spring high hand controlled chair
140-00124-03	Gas spring low foot controlled chair
140-00124-04	Gas spring medium foot controlled chair
140-00124-05	Gas spring high foot controlled chair

## Accessories

### Product code Description

140-00183-00	Foot support foot controlled chairs
140-00182-00	Foot support hand controlled chairs

## Assistant table Anna - for operating theatres

**Product code Description**

- 130-00105-00 Anna Tripod - assistant table with three wheels
- Height adjustment from 700 to 1100mm
  - Size of table top 700x500mm
  - Manage weight up to 20Kg
  - Individually braking castors, low friction
  - Battery powered, charger connect to table
  - Sound absorbing table top



- 130-00106-00 Anna Cross - assistant table with four wheels
- Height adjustment from 850 to 1350mm
  - Size of table top 1140x600 mm
  - Very stable, can manage up to 40Kg
  - Individually braking castors, low friction
  - Battery powered, charger connect to table
  - Sound absorbing table top



- 130-00106-01 Anna Cross - assistant table with fall edges and four wheels
- Fall edges so the Medical-guidewire for Endoscopic procedures remains on the table
  - Fall edges designed to prevent bacterial collections
  - Size of table top 1000x600 mm
  - Very stable, can manage up to 40Kg
  - Individually braking castors, low friction
  - Battery powered, charger connect to table
  - Sound absorbing table top



## Assistant table variants:

**Product code Description**

- 140-00149-00 Height adjustment 850-1350mm table 130-00105-00
- 140-00151-00 Table top size 600x400mm table 130-00105-00
- 140-00152-00 Table top size 1300x500mm table 130-00106-00
- 140-00152-01 Table top size 1200x600mm table 130-00106-00

## Armrests for operating theatre and examination

Product code	Description
150-00100-00	Rilis armrest R6 <ul style="list-style-type: none"> <li>• Unique safety armrest</li> <li>• Adjusted with great precision</li> <li>• Brackets fitting all of Rinis operator and assistants chairs</li> </ul>



150-00113-00	One grip armrest R7 <ul style="list-style-type: none"> <li>• Unique adjustment can be adjusted draped</li> <li>• Adjusted with great precision</li> <li>• Brackets fitting all of Rinis operator and assistants chairs</li> </ul>
--------------	---



## Armrest brackets

Product code	Description
000-03067-00	Bracket right/left elliptic
000-01130-00	Bracket right/left rectangular 30x15mm
140-00303-00	Bracket right/left ComfortMove special chair
140-00303-01	Bracket R/L elliptic with rail
000-06302-01	Clove right side
000-06301-01	Clove left side

## Undercarriages

Product code	Description
000-03577-01	Under carriage saddle chairs elliptic <ul style="list-style-type: none"> <li>• Jumper, Classic, MultiAdjuster, Swing, Perfect classic, Perfect lite</li> </ul>
000-03864-01	Under carriage Bambach elliptic
140-00200-00	Under carriage RiFlex Bambach
000-01325-01	Under carriage saddle chairs 30x15mm <ul style="list-style-type: none"> <li>• Amazone, Jumper, Perfect classic, Perfect lite</li> </ul>
000-03940-01	Under carriage Dynamic elliptic
000-01674-01	Under carriage CorrectSit 30x15mm



## Armrest for operation and health care

Product code	Description
000-03379-00	Armrest plate in molded seamless design
000-01327-00	Armrest plate arched
000-03395-00	Armrest plate 270x130mm
000-00431-00	Armrest plate 345x170mm



Product code	Description
140-00127-00	Arm 75° 400mm, ball joint for curved armrest
140-00180-00	Arm 105° 400mm long

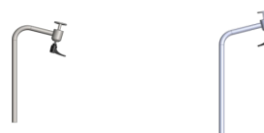

Product code	Description
000-03374-00	Bracket right elliptic
000-03375-00	Bracket left elliptic
000-03372-00	Bracket right rectangular 30x15mm
000-03373-00	Bracket left rectangular 30x15mm



## Ladder Lars

**Product code**   **Description**

- 160-00102-00   Step stool Lars with handle
- Height 300mm at highest step
  - Very stable, can manage up to 120Kg
  - Provided with anti-slip protection

- 160-00102-02   Step stool Lars 3 steps with handle
- Height 450mm at highest step
  - Very stable, can manage up to 120Kg
  - Provided with anti-slip protection





## 5. General Terms and Conditions

---

### 1. Orders, Prices etc.

All prices are exclusive of VAT and other taxes or official duties. A quotation shall be binding for Rini for thirty (30) days from the date of the offer, unless otherwise stated in writing.

Any information on weight, measurement, capacity etc. in catalogues, prospects, folders are estimates only. All technical data is provided subject to design modifications.

A change of customs, taxes or other official duties, which results in increased cost to Rini, entitles Rini to increase the offered or agreed price.

### 2. Payment

Orders are to be pre-paid before shipment if not otherwise agreed.

For customers with an established credit line, payment is due strictly thirty (30) days from date of invoice. Any payments not made when due shall accrue interest from the due date until the date payment is made at a per annum rate equal to 18 percentage and will result in that future orders are to be pre-paid.

### 3. Transportation and Packing

RINI handle packing and delivery of products according to "INCO TERMS Ex Works" or not otherwise agreed.

If other INCO TERMS are agreed for delivery, transportation, insurance and other handling fees will be charged in accordance with Rini's rates prevailing at the time of delivery. If the customer request express delivery, e.g. express cargo, courier, airfreight, the customer is obliged to compensate Rini for the actual cost of transportation in addition to the normal handling charge.

### 4. Risk of loss of Product

The risk of the product passes to the customer when Rini has delivered the product according to the agreed INCO TERM. Hence, Rini is only responsible for damage that may occur to the product up to the point in time when the risk passes to the customer.

### 5. Delivery time

The indicated delivery time starts when all terms in the purchase contract has been fulfilled. In case of pre-paid orders the delivery time starts when Rini has received payment. The product is considered to be delivered when risk of loss and damage passes to the customer in accordance with Section 4.

### 6. Inspection of Product

When a delivery is received the customer shall inspect the transportation packages and products for any transportation damages. If a transport damage has occurred, before the risk of the product has passed to the customer, the customer shall immediately report this to the shipping company and send a copy to Rini with full details of the damages including digital photo.

### 7. Warranty

RINI warrants that product sold at the time of the passing of risk as stipulated in Section 4 will be free from faults and shortcomings in construction, material and manufacture for 12 months. If the product is of the type requiring alignment or service, Rini is only responsible for faults remaining after such alignment or service has been carried out.

The customer shall immediately after the discovery of the fault or shortcoming make a claim to RINI in the form of a detailed description of the fault or shortcoming. However, such claim must be presented to Rini no later than 7 days after the day the customer discovered or ought to have discovered the fault or shortcoming.

After the receipt of a claim Rini will, at Rini's option, accept the return of the faulty product and reimburse the customer an amount equal to the purchase price, or repair or replace the faulty product.

Rini's responsibility for faults or shortcomings of delivered products is limited to the above. The customer is not entitled to any other remedies, but the above, in relation to faults or shortcomings.

### 8. Indirect Damages

The customer is not entitled to, and Rini is not in any event liable to pay, compensation for damages which the delivered product has caused to other property or to persons or any other consequential damages, including but not limited to loss of profit, loss of production or any other indirect damages.

In the event Rini would be held liable for compensation to third party for fault or safety shortcomings under the stipulations of, as it is called, product liability, the customer shall fully indemnify Rini for all damages finally awarded or settlement agreed, including Rini's costs in relation thereto, unless the damages caused by the fault or security shortcoming were due to gross negligence of Rini. Rini will give the customer notice of such claim and make it possible for the customer, if customer so wish, to influence the formulation of Rini's statement of defence or the terms to a possible settlement with the person presenting the claim, provided the customer issues a security, acceptable to Rini, for any costs or damages which can be imposed upon Rini.

### 9. Retention of Title

Products delivered shall remain the property of Rini until payment in full has been made.

### 10. Intellectual Property Rights

Customer is obliged to immediately notify Rini of any claim from third party alleging that products delivered under this Agreement infringes intellectual property rights (patent, registered design, trademark or copyright) of a third party. Provided customer present such claim immediately and provided customer grants Rini sole authority to defend or settle the case, Rini undertakes, at RINI expense, to defend the case, or come to a settlement, with the third party whose intellectual property rights has been infringed by the product delivered under this Agreement.

If it is held that a product delivered under this Agreement has infringed third party intellectual property rights Rini shall, at his own expense, and at Rini's option, obtain for the customer the right to continue using the product, replace or modify it so it becomes non-infringing or, in exchange for the return of the product, reimburse the price of the product. Rini is always entitled to deduct and the customer is obliged to pay an amount equal to the use of the product from the time of delivery to the claim was presented. If Rini has modified or developed a new product upon customer instructions or specifications, customer shall fully reimburse Rini for any and all costs and damages that might occur as a result of the modified or new product infringing third party intellectual property rights.

### 11. Force Majeure

If either party is prevented from performing under this Agreement due to force majeure the other party may not establish any sanctions for this reason. However, if the hindrance regards the customer's possibility to carry out payment Rini is entitled to withhold delivery of the product until payment has been effected. If the hindrance to effect payment last for more than four (4) weeks Rini is entitled to cancel the purchase.

The term "force majeure" means in this Agreement that the performance under the agreement is prevented, aggravated or delayed due to war, rebellion or riot, mobilization or unexpected call for military service of similar dimensions, requisition, seizure, exchange restrictions, export- or import restrictions, general scarcity of merchandise, shortage of transportation, labour conflict, restrictions on fuel and power, fire, faulty or delayed deliveries from subcontractors due to above causes, as well as any other circumstance beyond the control of the party.

### 12. Governing Law and Disputes

This agreement and any disputes hereunder shall be governed by Swedish law.

Any legal action relating to this Agreement and all legal relationships associated with it shall be decided by District Court of Stockholm as exclusive jurisdiction of first instance. However, RINI is entitled to turn to the district court or the Enforcement Service in the county or city where the customer has his legal domicile as regards claim for payment due.

The fact that a dispute has occurred does not exempt the customer to make payment due or to fulfil any other obligations under the agreement.

### 13. Miscellaneous

Either party's failure to enforce breach of this Agreement or to exercise its rights due to such breach shall not be deemed a waiver of such rights to enforce any future breach of agreement.

What is stated in this document as regards all matters contained is the full and exhaustive description of RINI's responsibilities and the rights of the customer. As regards such matters dealt with the customer is not entitled to any other remedy or compensation.

Stockholm May 2009

**Distribuidor España y Portugal**

C/ Polo Sur, 1

28850 Madrid (Spain)

Tel. +34 91 676 47 97

email: [info@medicontur.es](mailto:info@medicontur.es)

[www.medicontur.es](http://www.medicontur.es)